

ASSEMBLE DISPOSABLE TUBE

To form the Disposable Tube, ensure tabs go from the outside of the Tube, inwards. The tabs should be concealed once inserted. Once assembled, the Tube can be placed on the Mandrel Carriage. See steps A – C below.

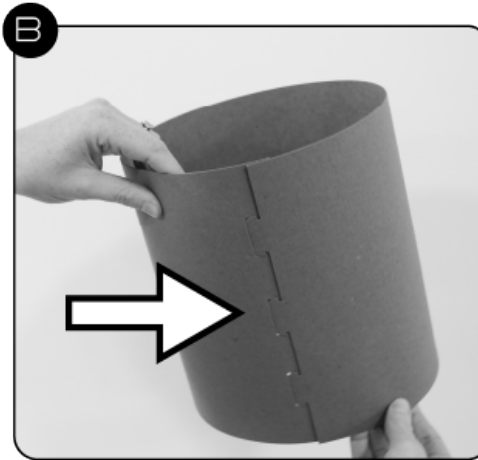
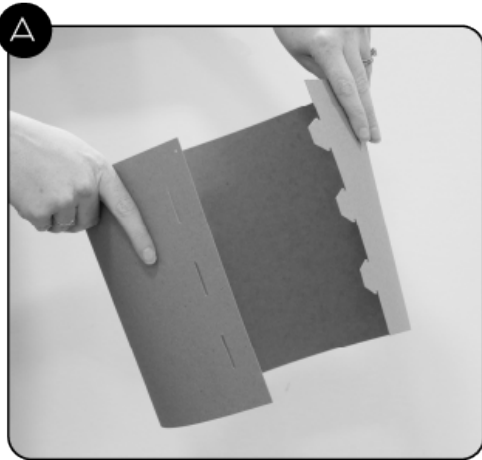

To ensure proper use of your WRAP unit, read through the entire User Guide prior to machine use. The User Guide is available online via the following link: <https://onulis.com/user-guides>

For any questions about your purchase, please reach out to the following:

- **General Inquiries:** info@onulis.com
- **Support Request:** maintenance@onulis.com
- **Purchases:** orders@onulis.com